

# TECHNICAL DATA SHEET

## 6PZS195



### Applications



CYCLIC



SOLAR



MARINE

### Specifications:

Type of traction battery:	<b>Golf Cart T 6V - 195Ah</b>
Nominal capacity (C <sub>5</sub> ):	<b>195 Ah</b> (acc.to EN 60 254-1, IEC 254-1)
Nr. of cycles:	1200 (acc.to EN 60 254-1, IEC 254-1)
Final voltage at C <sub>5</sub> :	1,70 V/cell; 5,10 V/block
Capacities C <sub>10</sub> , C <sub>20</sub> , C <sub>120</sub> :	200, 218, 240 Ah
Dimensions:	244 x 190 x 270 mm
Mass of cell (±5%)	30,5 kg – with electrolyte 23,1 kg – without electrolyte
Electrolyte density:	1,28 ± 0,01 kg/l

### Technology:

Battery type:	Flooded lead –acid
Pos. plate type:	Tubular
Neg. plate type:	Casted Grid
Grid alloy (pos./neg.):	Sb/Sb
Separator:	microporous

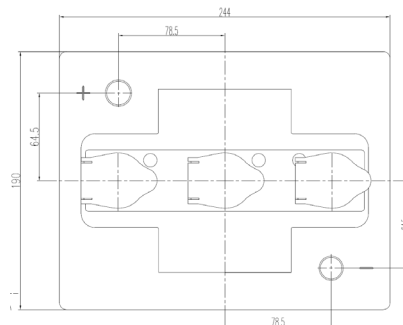
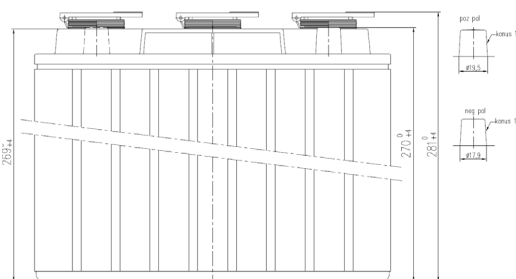

### Charging

Suggested Charging current	25A WA 20 IU1A
Operating Temperature	-20°C / 45°C
Storage Temperature	-20°C / 40°C
Cycle nr.	1200

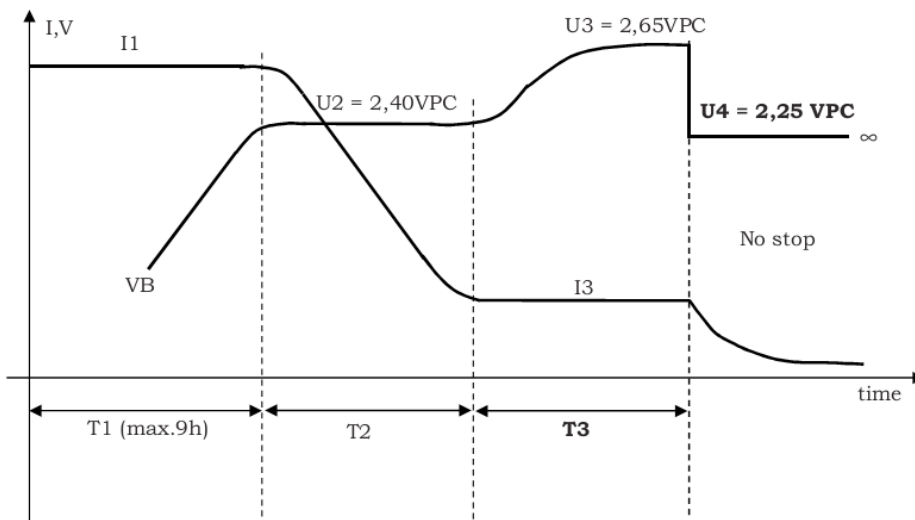

Duur: T1 + T2: De duur van de eerste twee fases is hoogstens 14u

Duur: T3: De duur T3 is gelijk aan de duur van de hoofdlading, dat is  $t_3 = t_1 + t_2$ , maar met een minimum van 1 tot 4h

T1 + T2 [h]	< 1	2	3	4	> 4
T3 [h]	1	2	3	4	4