

# TECHNICAL DATA SHEET

9.580.3



## Applications



CYCLIC



SOLAR



MARINE

## Electrical specification

Voltage:	<input type="text" value="12V"/>	(V)
Capacity C20:	<input type="text" value="100"/>	(Ah)
Capacity C5:	<input type="text" value="80"/>	(Ah)
RC:	<input type="text" value="182"/>	(min)

## Mechanical specification

Dimensional group:	<input type="text" value="-"/>	JIS D 5301:2006
ETN reference:	<input type="text" value="957 052 000"/>	
DIN reference:	<input type="text" value="95752"/>	
Sizes:	<input type="text" value="304x175x220"/>	(L x W x H)
Cell Layout:	<input type="text" value="0"/>	
Terminal Type:	<input type="text" value="1"/>	

## Container

<u>Case</u>	Material	<input type="text" value="POLYPROPYLENE"/>	Colour	<input type="text" value="BLACK"/>
	Bottom hold down	<input type="text" value="B1"/>	Handles	<input type="text" value="-"/>
<u>Lid</u>	Material	<input type="text" value="POLYPROPYLENE"/>	Colour	<input type="text" value="BLACK"/>
	Cover design	<input type="text" value="FLAT"/>	Handles	<input type="text" value="BLACK"/>
<u>Vent cap</u>	Material	<input type="text" value="POLYPROPYLENE"/>	Colour	<input type="text" value="BLACK"/>
	Type	<input type="text" value="FLAT"/>		

## Test details

Vibration resistance:  Separator: Type:

Endurance resistance:

Battery weight:  ± 1.00 (Kg)

Acid weight:  ± 0.50 (Kg)

Total battery weight:  ± 1.50 (Kg)

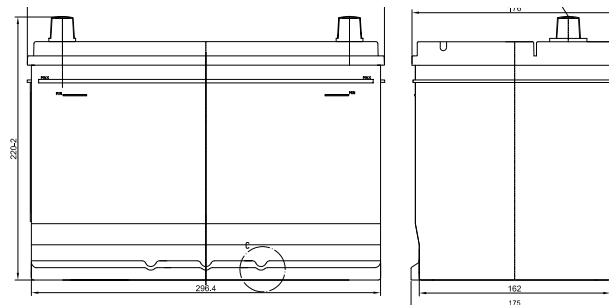
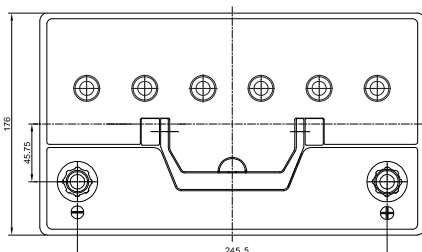

### Charging

Suggested Charging current	25A WA 20 IU1A
Operating Temperature	-20°C / 45°C
Storage Temperature	-20°C / 40°C
Cycle nr.	600

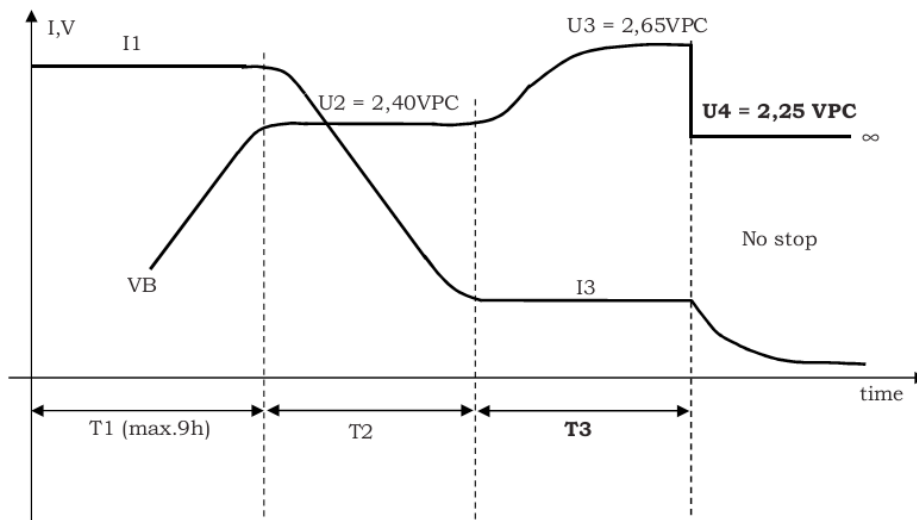

Duur: T1 + T2: De duur van de eerste twee fases is hoogstens 14u

Duur: T3: De duur T3 is gelijk aan de duur van de hoofdlading, dat is  $t_3 = t_1 + t_2$ , maar met een minimum van 1 tot 4h

T1 + T2 [h]	< 1	2	3	4	> 4
T3 [h]	1	2	3	4	4